

Cautions:

1. DO NOT use an electric generator to test this LED fixture.
2. Please abide by any related country, regional and local laws and regulations when installing this fixture.
3. To avoid any electrical shock or damage, please do not install on rainy days.

Notices:

1. To prevent the risk of fire or electric shock, the installation must be conducted by operator who has professional electrical knowledge.
2. Please wear gloves to avoid injury before installing lamps.
3. During or after installation, if there are situations such as smoke, fire in the fixture, please turn off the power immediately.
4. This light can be used for outdoor installation.

Parameters

Part No.	Input Voltage	Frequency	Power	Rated Current
AL150WSCCTBK5	AC120-347V	50/60Hz	70W/100W/150W Selectable	1.375A
AL300WSCCTBK5			200W/240W/300W Selectable	2.75A

CCT or Watts selected Operation Manual:

Fixture Power (W) and/or Color Temperature (CCT) from factory settings are:

AL150WSCCTBK5 150W/50K

AL300WSCCTBK5 300W/50K

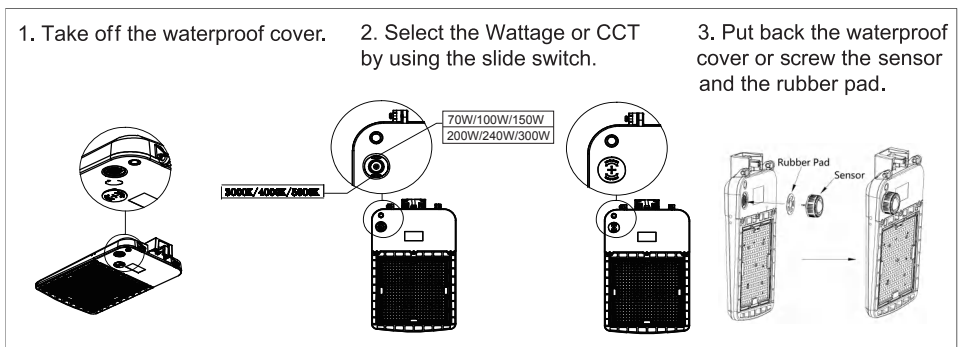

Wiring Diagram:

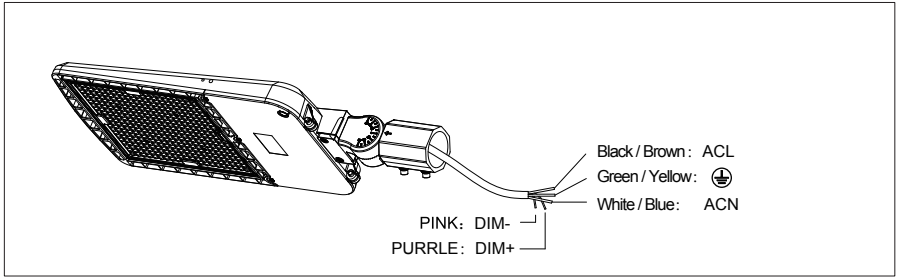

Optional Brackets and Installation Instructions

There are 4 optional brackets for this fixture.

The following are shoebox fixtures with different brackets.

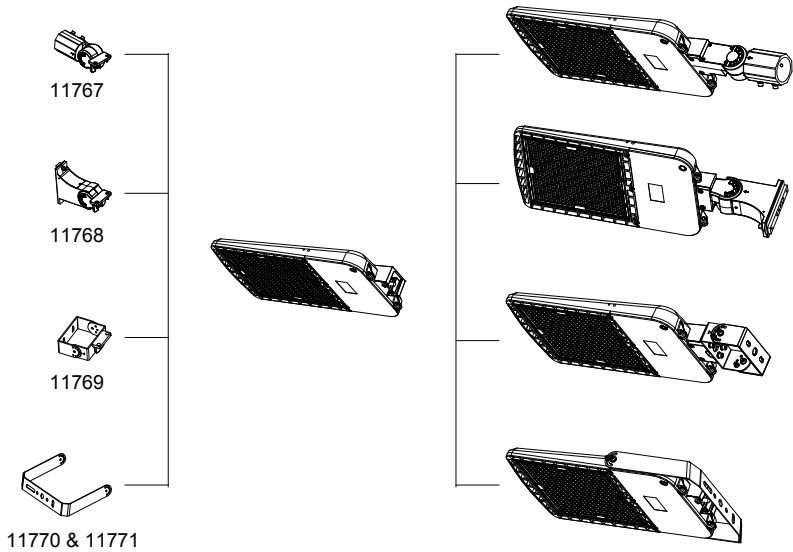

Step 1 : Disassemble the slip-fitter with a wrench.

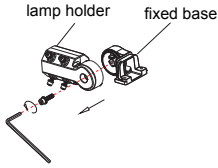

Step 2: Pass the fixture's AC input wires through the fixing base, then tighten screws to assemble fixing base to fixture body.

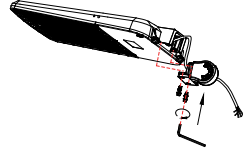

Step 3: Pass the fixture's input wires through the lamp holder and lock it.

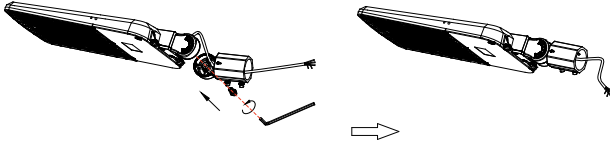

Step 4: Loosen the 4 locking bolts in the Type A bracket by a wrench.

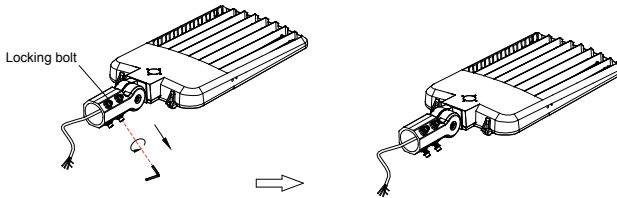

Step 5: Connect the fixture's AC input wires to pole-wires with connectors, L to L (black), N to N (White), PE to PE (Green); If need to connect dimming wires from the pole to fixture, please also use the connector to connect "Dim +"(purple) to "Dim -"(pink).

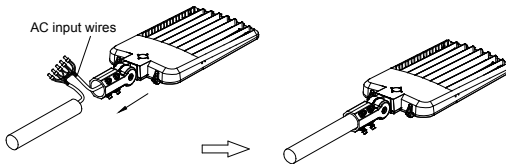

Step 6: Tighten the 4 locking bolts back.

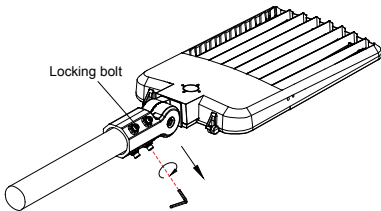

Step 7 :Loosen the locking bolt in the slip-fitter by a wrench to adjust fixture to a appropriate angle,adjustable angle range 90 then this locking bolt.

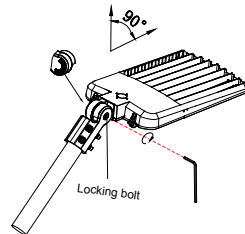

11768 – (Square/Round pole-mount with slip-fitter function)

Step 1 : Disassemble the bracket with a wrench, open the cover on the lamp holder.

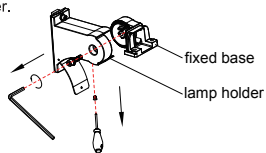

Step 2: Pass fixture's AC input wires through fixing base, tighten screws to assemble fixing base to fixture body.

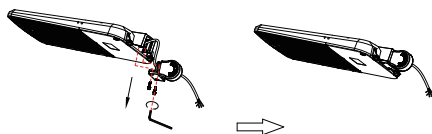

Step 3: Pass the fixture's input wires through the lamp holder and lock it.

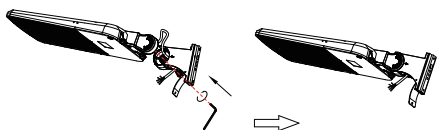

Step 4: Remove the screws with screwdriver, well set the installed iron bar, remove the screws to open the junction box cover, then pass fixture's AC input wires through junction box as shown in step 3.

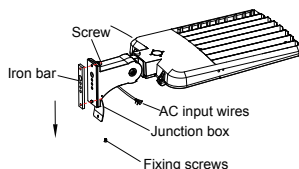

Step 5: When install to square/round pole, align the holes of Type B bracket and pole, pass the fixing screws throughout both holes, then put iron bar inside of pole to attach screws.

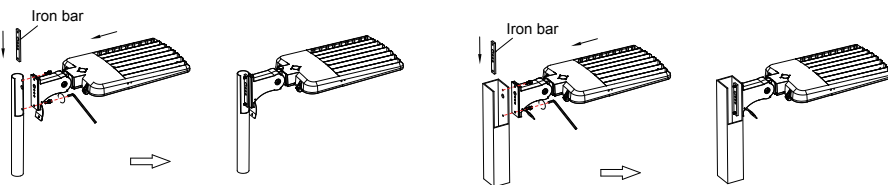

Attention: When install round pole, please remove the rubber gasket.

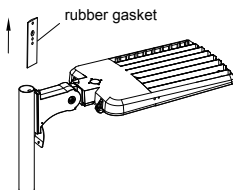

Step 6: 1. Pass the fixture's AC input wires through pole, pull them out together the pole-wires for connection, 2. Pass the pole-wires into Type B bracket, pull them out together with fixture's AC wire from junction box, connect the fixture's AC input wires to pole-wires with connectors, L to L (black), N to N (White), PE to PE (Green); If need to connect dimming wires from the pole to fixture, please also use the connector to connect "Dim +" (purple) to "Dim +" (purple), "Dim -" (pink) to "Dim -" (pink).

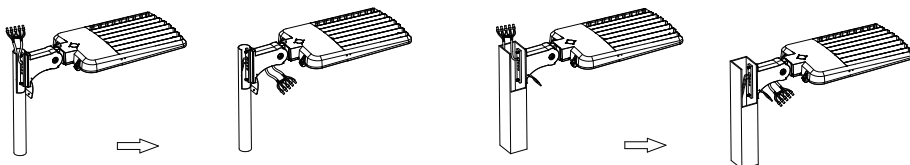

Step 7 : 1. Push the connected wires into the pole, close the pole's top cover, the close the junction box cover by tightening the screws.

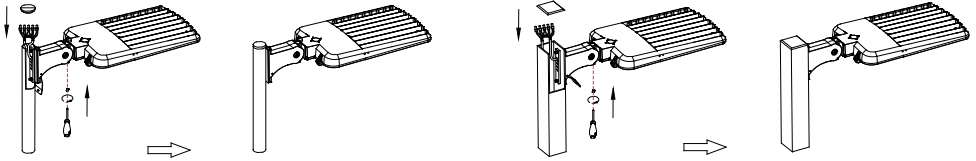

Step 7 : 2. Push the connected wires into bracket junction box, close the box cover by tightening the screws, then close the pole's top cover.

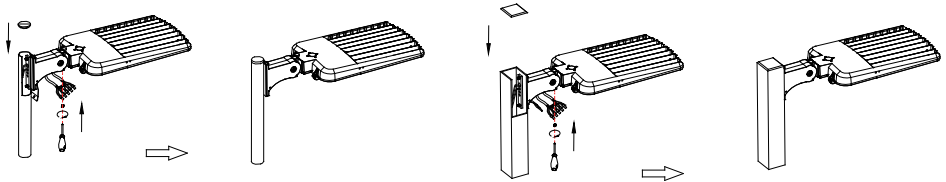

Step 8 : Loosen the locking bolt by a wrench to adjust the fixture to a appropriate angle, adjustment range 15°, then tighten this locking bolt.

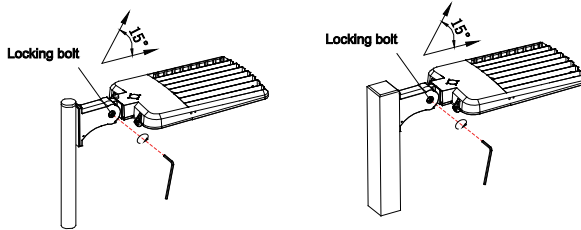

11769 – (Trunnion)

Step 1 : Mark the fixing holes locations on the wall with Type D bracket, then drill the hole in 10mm diameter with an electric drill;

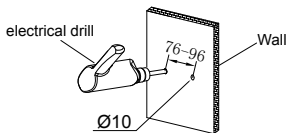

Step 2 : Knock the two expansion bolts into wall with a hammer

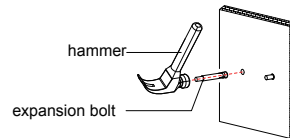

Step 3: Fix the TYPE D bracket on the mounting-surface by tightening screws with a wrench.

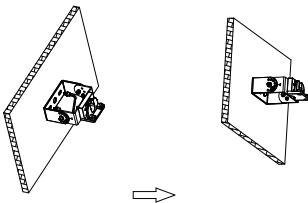

Step 4: Pass the fixture's AC input wires through the Type D bracket; then hang the fixture into the TYPE D bracket, tighten screws to lock it to Type D bracket with a wrench.

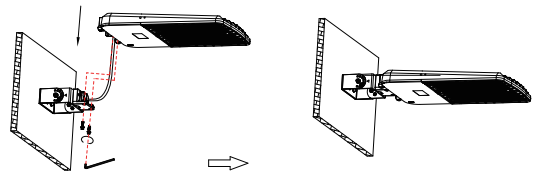

Step 5: Loosen the angle adjustable screws on both sides of Type D bracket, rotate fixture to an appropriate angle required and tighten the two screws, see fig.31; then connect the fixture's
 Note: The adjustable angel range is 0-90°.

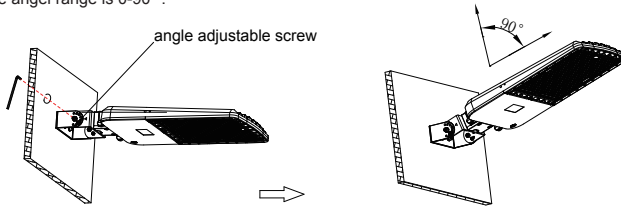

11770 & 11771 – (Yoke) Installation

Step 1. Loosen the screws on both sides of the bracket with a wrench, adjust TYPE E bracket's angle to keep parallel with its installation surface.

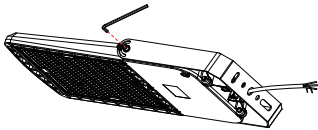

Step 2: Mark the installing hole locations on the wall with Type E bracket, then drill the holes in 10mm diameter with an electric drill.

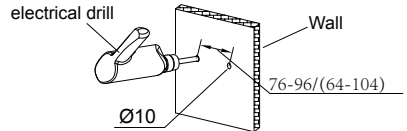

Step 3: Knock the one expansion bolt into each wall-hole with a hammer.

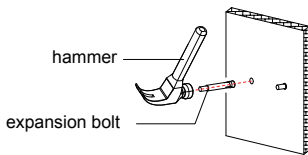

Step 4: Put Type E bracket to expansion screw for wall-installing by tightening the nut with a wrench, connect fixture's AC input wire to L N PE, then make waterproof processing to joints, put wires back into junction box.

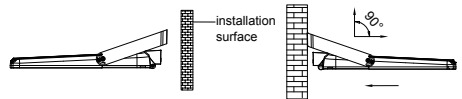

Note: The adjustable angel range is 0-90°.